

R22HT

Planetary Gearbox

∅22mm

3.7Nm

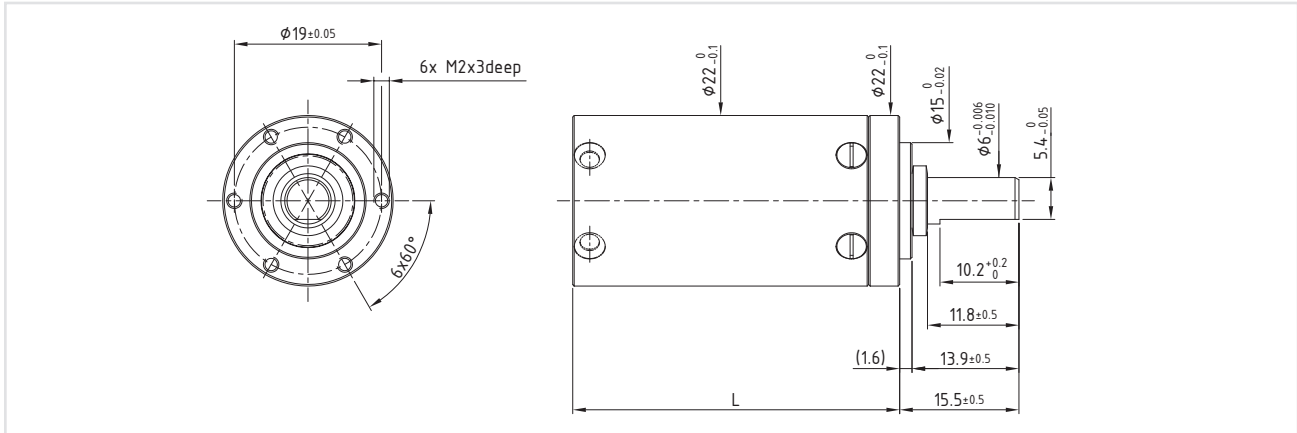

|                        |  |            |                       |         |         |         |                          |         |         |         |
|------------------------|--|------------|-----------------------|---------|---------|---------|--------------------------|---------|---------|---------|
| Ratio                  | ****   | 10.9       | 16.4                  | 36.5    | 61.7    | 88.8    | 120.9                    | 211.4   | 294.4   | 423.9   |
|                        |  | 12.4       | 17.9                  | 41.2    | 63.7    | 96.7    | 136.7                    | 222.6   | 316.1   | 455.2   |
|                        |  | 14.1       | 19.2                  | 46.6    | 67.1    | 103.8   | 154.6                    | 231.2   | 320.6   | 479.5   |
|                        |  | 14.5       | 20.2                  | 48.2    | 72.1    | 109.4   | 159.8                    | 239.0   | 333.0   | 522.1   |
|                        |  |            | 23.7                  | 52.7    | 75.9    | 127.9   | 174.8                    | 251.8   | 344.2   | 560.6   |
|                        |  | 29.2       | 54.5                  | 78.5    | 157.5   | 180.8   | 260.3                    | 362.6   | 590.5   |         |
|                        |  |            | 59.4                  | 84.3    |         | 196.8   | 270.3                    | 369.6   | 690.4   |         |
|                        |  |            |                       |         |         | 197.8   | 279.5                    | 389.3   | 850.3   |         |
|                        |  |            |                       |         |         | 204.4   | 284.8                    | 410.1   |         |         |
| 1                      | Number of Gear Stages                              | 2          | 2                     | 3       | 3       | 3       | 4                        | 4       | 4       | 4       |
| 2                      | Direction of Rotation                              | =          | =                     | =       | =       | =       | =                        | =       | =       | =       |
| 3                      | Efficiency   | 0.82       | 0.82                  | 0.72    | 0.72    | 0.72    | 0.62                     | 0.62    | 0.62    | 0.62    |
| 4                      | Length(L)  | mm         | 28.3                  | 28.3    | 35.1    | 35.1    | 35.1                     | 41.9    | 41.9    | 41.9    |
| 5                      | Weight   | g (oz)     | 52                    | 52      | 66      | 66      | 66                       | 81      | 81      | 81      |
|                        |  |            | (1.834)               | (1.834) | (2.328) | (2.328) | (2.328)                  | (2.857) | (2.857) | (2.857) |
| 6                      | Available with Motor - L2 = Length with motor (mm) |            |                       |         |         |         |                          |         |         |         |
|                        | 22DCP / 22DCT / 22N78 / 24DCT                      |            | 62.7                  | 62.7    | 69.5    | 69.5    | 69.5                     | 76.3    | 76.3    | 76.3    |
|                        | 22NT82   |            | 62.5                  | 62.5    | 69.3    | 69.3    | 69.3                     | 76.1    | 76.1    | 76.1    |
|                        | 22N98  |            | 64.6                  | 64.6    | 71.4    | 71.4    | 71.4                     | 78.2    | 78.2    | 78.2    |
|                        | 23GST2R  |            | 68.7                  | 68.7    | 75.5    | 75.5    | 75.5                     | 82.3    | 82.3    | 82.3    |
|                        | 25GT2R   |            | 84.2                  | 84.2    | 91      | 91      | 91                       | 97.8    | 97.8    | 97.8    |
|                        | 25GST2R  |            | 74.2                  | 74.2    | 81      | 81      | 81                       | 87.8    | 87.8    | 87.8    |
|                        | 22ECP45  |            | 73.3                  | 73.3    | 80.1    | 80.1    | 80.1                     | 86.9    | 86.9    | 86.9    |
|                        | 22ECP60 / 22ECT60                                  |            | 88.3                  | 88.3    | 95.1    | 95.1    | 95.1                     | 101.9   | 101.9   | 101.9   |
|                        | 22ECT82  |            | 110.3                 | 110.3   | 117.1   | 117.1   | 117.1                    | 123.9   | 123.9   | 123.9   |
| <b>Characteristics</b> |  |            | <b>R22HT 2R . 0 .</b> |         |         |         |                          |         |         |         |
| 7                      | Shaft Bearings                                     |            | Ball Bearing          |         |         |         |                          |         |         |         |
| 8                      | Max. Continuous Torque                             | Nm (oz-in) | 2.4                   | 2.4     | 3.3     | 3.3     | 3.3                      | 3.7     | 3.7     | 3.7     |
|                        |  |            | (340)                 | (340)   | (467)   | (467)   | (467)                    | (524)   | (524)   | (524)   |
| 9                      | Max. Continuous Power                              | W          | 32.4                  | 32.4    | 16.2    | 16.2    | 16.2                     | 8.7     | 8.7     | 8.7     |
| 10                     | Maximum Static Torque                              | Nm (oz-in) | 3                     | 3       | 3.8     | 3.8     | 3.8                      | 4.2     | 4.2     | 4.2     |
|                        |  |            | (425)                 | (425)   | (538)   | (538)   | (538)                    | (595)   | (595)   | (595)   |
| 11                     | Maximum Radial Force                               |            |                       |         |         |         |                          |         |         |         |
|                        | @ 10mm from mounting face                          | N (lb)     |                       |         |         |         | 150 (33.7)               |         |         |         |
| 12                     | Maximum Axial Force                                | N (lb)     |                       |         |         |         | 100 (22.4)               |         |         |         |
| 13                     | Maximum Press Fit Force                            | N (lb)     |                       |         |         |         | 120 (26.9)               |         |         |         |
| 14                     | Average Backlash @ no-load                         | (deg)      | 1.2°                  | 1.2°    | 1.6°    | 1.6°    | 1.6°                     | 1.9°    | 1.9°    | 1.9°    |
| 15                     | Shaft Play:  |            |                       |         |         |         |                          |         |         |         |
|                        | -Radial (@ 10mm from flange)                       | µm         |                       |         |         |         | ≤ 200                    |         |         |         |
|                        | -Axial   | µm         |                       |         |         |         | <30                      |         |         |         |
| 16                     | Maximum Recommended Input Speed                    | rpm        |                       |         |         |         | 12000                    |         |         |         |
| 17                     | Operating Temperature Range:                       | °C (°F)    |                       |         |         |         | -30 to +85 (-22 to +185) |         |         |         |

Motor + gearbox = L2

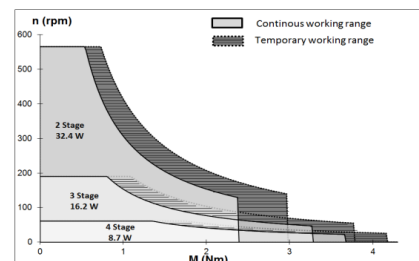

V041017