

**K24**

Spur Gearbox

Ø 24mm

0.17 Nm

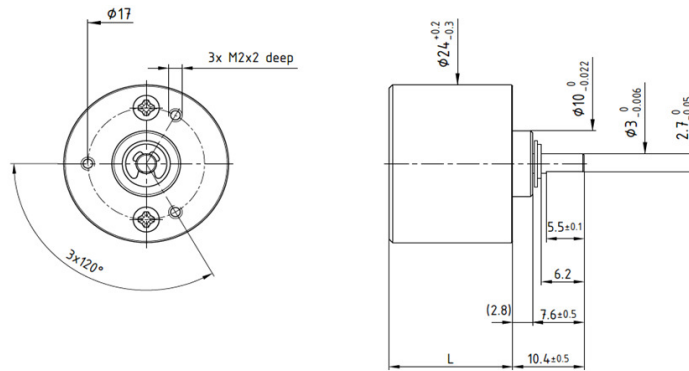

Dimensions in mm

Ratio	****	5	8	20	32	64	128	320	800	2048	
1	Number of Gear Stages	2	2	4	4	4	4	6	6	6	
2	Direction of Rotation	=	=	=	=	=	=	=	=	=	
3	Efficiency	0.85	0.85	0.75	0.75	0.75	0.75	0.65	0.65	0.65	
4	L (mm)	15	15	18	18	18	18	21	21	21	
5	Weight g (oz)	15 (0.529)	15 (0.529)	18 (0.634)	18 (0.634)	18 (0.634)	18 (0.634)	20 (0.705)	20 (0.705)	20 (0.705)	
6	Available with Motor - L2 = Length with motor (mm)										
	<b>22V28</b>	49.4	49.4	52.4	52.4	52.4	52.4	55.4	55.4	55.4	
	<b>22V48</b>	51.2	51.2	54.2	54.2	54.2	54.2	57.2	57.2	57.2	
	<b>22N78</b>	47	47	50	50	50	50	53	53	53	
	<b>22N98</b>	48.9	48.9	51.9	51.9	51.9	51.9	54.9	54.9	54.9	
	<b>26N58</b>	58.3	58.3	61.3	61.3	61.3	61.3	64.3	64.3	64.3	
	<b>26N48</b>	57.1	57.1	60.1	60.1	60.1	60.1	63.1	63.1	63.1	
	<b>P310</b>	32.4	32.4	35.4	35.4	35.4	35.4	38.4	38.4	38.4	
	<b>22DCP/24DCT</b>	50.2	50.2	53.2	53.2	53.2	53.2	56.2	56.2	56.2	
<b>Characteristics</b>				<b>K24 • 0 • ....</b>				<b>K24 2R • 0 • ....</b>			
7	Shaft Bearings					Sleeve				Ball Bearing	
8	Maximum Static Torque	Nm (oz-in)				0.7 (100)				0.7 (100)	
9	Maximum Radial Force										
	@ 8mm from mounting face	N (lb)				5 (1.1)				20 (4.5)	
10	Maximum Axial Force	N (lb)				8 (1.8)				10 (2.2)	
11	Maximum Press Fit Force	N (lb)				30 (6.7)				30 (6.7)	
12	Average Backlash @ no-load					1.5°				1.5°	
13	Average Backlash @ 0.3 Nm					2.5°				2.5°	
	Shaft Play:										
14	-radial	µm				≤ 40				≤ 10	
15	-axial	µm				50-150				≤ 10	
16	Maximum Recommended Input Speed	rpm				5000				5,000	
17	Operating Temperature Range:	°C (°F)				-30 to +65 (-22 to +150)					

**Motor + gearbox = L2**

