

20DBM-L

Ø 20 mm • RoHS Compliant • 50 N

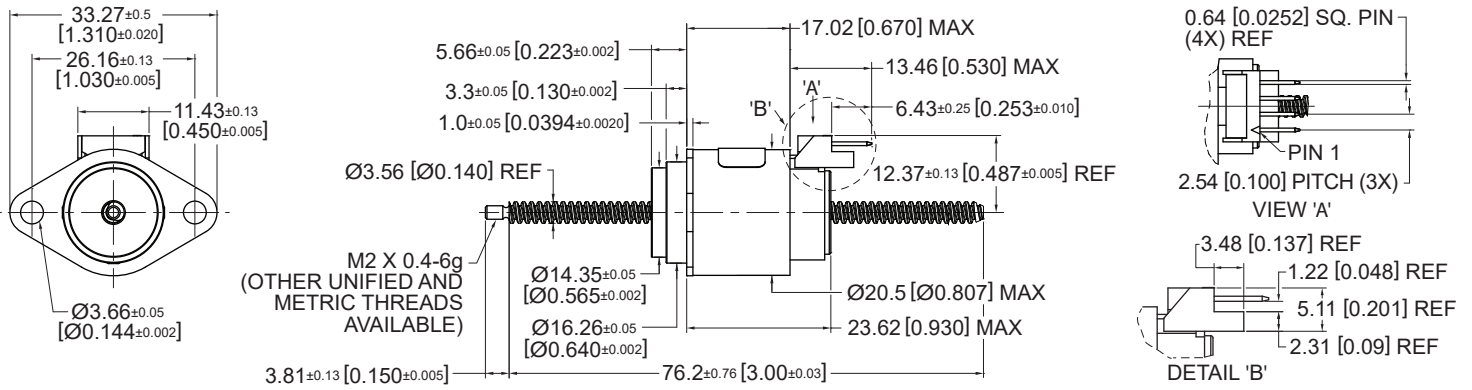

Dimensions in mm [inches]

| Electrical Data | 20DBMXX●●●-L | | | | Unit |
|---------------------------------------|--------------|-------------|-------------|-------------|------|
| | D2B Bipolar | D1B Bipolar | D3B Bipolar | D4B Bipolar | |
| 1 Operating Voltage # | 12 | 5 | 2.9 | 1.4 | VDC |
| 2 Resistance per Phase, ± 10% | 100.5 | 17.5 | 5.7 | 1.4 | Ohms |
| 3 Inductance per Phase, typ | 45.0 | 7.0 | 2.4 | 0.6 | mH |
| 4 Rated Current per Phase, 1 Phase ON | 0.17 | 0.41 | 0.71 | 1.41 | A |
| 5 Input Power | 2.9 | 2.9 | 2.9 | 2.9 | W |

| General Data | XX | Linear travel per step | | |
|--|----|------------------------|-------------------------|---------|
| 6 Min. Holding Force @ rated current | 05 | @ .0005" (0.0127mm) | 50 (180) | N (oz) |
| | 10 | @ .001" (0.0254mm) | 35 (126) | N (oz) |
| | 20 | @ .002" (0.0508mm) | 22 (79) | N (oz) |
| 7 Min. Holding Force (Unenergized) | 05 | @ .0005" (0.0127mm) | 50 (180) | N (oz) |
| | 10 | @ .001" (0.0254mm) | 13.9 (50) | N (oz) |
| | 20 | @ .002" (0.0508mm) | 5.5 (20) | N (oz) |
| 8 Stroke Length, Typ | | | 50 (1.97) | mm (in) |
| 9 Linear Travel Accuracy | | | ± 1 Step | |
| 10 Steps per Revolution | | | 48 | |
| 11 Ambient Temperature Range (operating) | | | -20 to +70 (-4 to +158) | °C (°F) |
| 12 Maximum Coil Temperature | | | 130 (266) | °C (°F) |
| 13 Bearing Type | | | Ball Bearing | |
| 14 Insulation Resistance at 500 VDC | | | 20 | Mohms |
| 15 Dielectric Withstanding Voltage | | | 650 for 2 seconds | VAC |
| 16 Weight | | | 35 (1.23) | g (oz) |
| 17 Leadwire | | | | |

Notes: 1. All motor data values at 20° C unless otherwise specified – 2. # Voltage in case of voltage driver (indicator R=1)

