

## 26M024B

Ø 26 mm • RoHS Compliant • 7.8 mNm

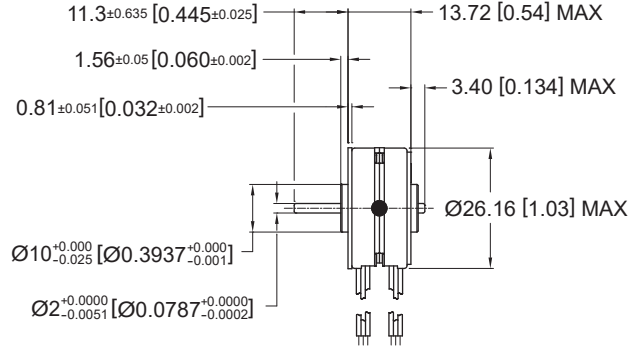
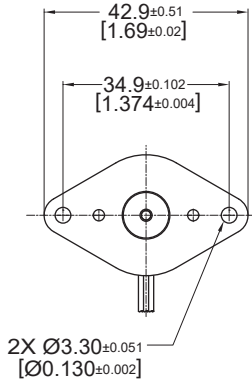

Dimensions in mm [inches]

Electrical Data	26M024B••				Unit
	1U Unipolar	2U Unipolar	1B Bipolar	2B Bipolar	
1 Operating Voltage	5	12	5	12	VDC
2 Resistance per Phase, ± 10%	19.6	110.0	19.8	108.0	Ohms
3 Inductance per Phase, typ	4.1	29.9	7.7	52.4	mH
4 Rated Current per Phase *	0.26	0.11	0.25	0.11	A
<b>Coil Independent Parameters</b>					
5 Holding Torque, MIN *	6.3 (0.9)	6.3 (0.9)	7.8 (1.1)	7.8 (1.1)	mNm (oz-in)
6 Detent Torque, Max			1.34 (0.19)		mNm (oz-in)
7 Rotor Inertia			1.1 (0.00601)		gcm <sup>2</sup> (oz-in <sup>2</sup> )
8 Step Angle			15.0		Degree
9 Absolute accuracy 2 ph. On, Full step			± 1		Degree
10 Steps per Revolution			24		
11 Ambient Temp Range (operating)			-20 to +70 (-4 to +158)		°C (°F)
12 Maximum Coil Temperature			130 (266)		°C (°F)
13 Bearing Type			Sintered Bronze Sleeve		
14 Insulation Resistance at 500 VDC			100		Mohms
15 Dielectric Withstanding Voltage			650 for 2 seconds		VAC
16 Weight			34 (1.2)		g (oz)
17 Leadwire			AWG #28, UL1429 (80° C, 150 V)		

Note: All motor data values at 20° C unless otherwise specified

\* Engergize at rated current, 2-Phase On

