

26M048D

Ø 26 mm • RoHS Compliant • 14.5 mNm

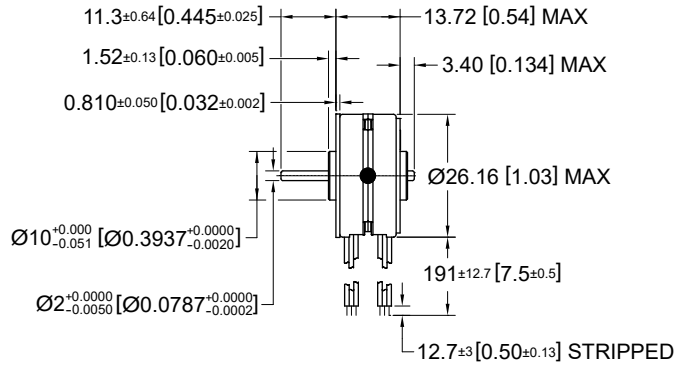
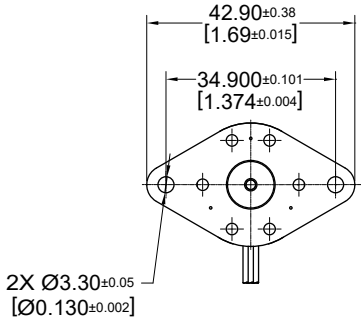

Dimensions in mm. [inches]

Electrical Data	26M048D••				Unit
	1U Unipolar	2U Unipolar	1B Bipolar	2B Bipolar	
1 Operating Voltage	5	12	5	12	VDC
2 Resistance per Phase, ± 10%	19.6	110.0	19.8	108.0	Ohms
3 Inductance per Phase, typ	4.9	33.0	12.0	55.0	mH
4 Rated Current per Phase *	0.26	0.11	0.25	0.11	A
Coil Independent Parameters					
5 Holding Torque, MIN *	11.5 (1.63)	11.5 (1.63)	14.5 (2.05)	14.5 (2.05)	mNm (oz-in)
6 Detent Torque, Max	4.2 (0.6)				mNm (oz-in)
7 Rotor Inertia	1.1 (0.00601)				gcm ² (oz-in ²)
8 Step Angle	7.5				Degree
9 Absolute accuracy 2 ph. On, Full step	± 0.5				Degree
10 Steps per Revolution	48.0				
11 Ambient Temp Range (operating)	-20 to +70 (-4 to +158)				°C (°F)
12 Maximum Coil Temperature	130 (266)				°C (°F)
13 Bearing Type	Sintered Bronze Sleeve				
14 Insulation Resistance at 500 VDC	100.0				Mohms
15 Dielectric Withstanding Voltage	650 VRMS for 2 seconds				VAC
16 Weight	34 (1.2)				g (oz)
17 Leadwire	AWG #28, UL 1429 (80° C, 150 V)				

Note: All motor data values at 20° C unless otherwise specified
 * Engergize at rated current, 2-Phase On

