

**R16**

Ø 16 mm • Planetary Gearbox • 0.3 Nm

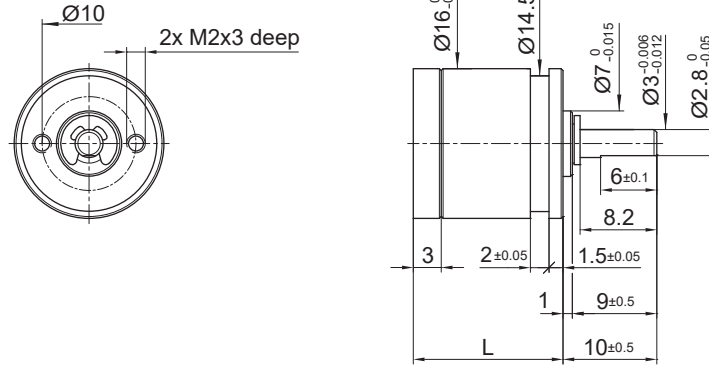

Dimensions in mm

Ratio	5.5	22	30.2	88	121	166	352	484	665.5	915
1 Number of Gear Stages	1	2	2	3	3	3	4	4	4	4
2 Direction of Rotation	=	=	=	=	=	=	=	=	=	=
3 Efficiency	0.85	0.75	0.75	0.65	0.65	0.65	0.55	0.55	0.55	0.55
4 L (mm)	16	20.1	20.1	24.2	24.2	24.2	28.3	28.3	28.3	28.3
5 Weight	g (oz)	10 (0.352)	13 (0.458)	13 (0.458)	16 (0.564)	16 (0.564)	16 (0.564)	19 (0.670)	19 (0.670)	19 (0.670)

6 Available with Motor – L2 - Length with motor (mm)	5.5	22	30.2	88	121	166	352	484	665.5	915
16C18	31.7	35.8	35.8	39.9	39.9	39.9	44	44	44	44
16N78	44	48.1	48.1	52.2	52.2	52.2	56.3	56.3	56.3	56.3
16G88	44	48.1	48.1	52.2	52.2	52.2	56.3	56.3	56.3	56.3
17S78	34.7	38.8	38.8	42.9	42.9	42.9	47	47	47	47
17N78	41.9	46	46	50.1	50.1	50.1	54.2	54.2	54.2	54.2
P110	35	39.1	39.1	43.2	43.2	43.2	47.3	47.3	47.3	47.3
16DCP/16DCT/17DCT CB	42	46.1	46.1	50.2	50.2	50.2	54.3	54.3	54.3	54.3
16DCP/16DCT/17DCT PM	41.5	45.6	45.6	49.7	49.7	49.7	53.8	53.8	53.8	53.8
16ECP36	50.5	54.6	54.6	58.7	58.7	58.7	62.8	62.8	62.8	62.8
16ECP52	66.5	70.6	70.6	74.7	74.7	74.7	78.8	78.8	78.8	78.8
32BF	27.2	31.3	31.3	35.4	35.4	35.4	39.5	39.5	39.5	39.5

Characteristics	Unit	R16 • 0 • ....	R16 2R • 0 • ....
7 Shaft Bearings		Sleeve	Ball Bearing
8 Maximum Static Torque	Nm (oz-in)	1 (141)	1 (141)
9 Maximum Radial Force @ 8mm from mounting face	N (lb)	5 (1.12)	20 (4.5)
10 Maximum Axial Force	N (lb)	8 (1.8)	10 (2.2)
11 Maximum Press Fit Force	N (lb)	100 (23)	100 (23)
12 Average Backlash @ no-load		1.25°	1.25°
13 Average Backlash @ 0.3 Nm		2°	2°
Shaft Play:			
14 -radial	µm	≤ 20	≤ 10
15 -axial	µm	50-150	≤ 50
16 Maximum Recommended Input Speed	rpm	7,500	7,500
17 Operating Temperature Range:	°C (°F)	-30 to +65 (-22 to +150)	

