

26DAM-L

Ø 26 mm • RoHS Compliant • 33.4 N

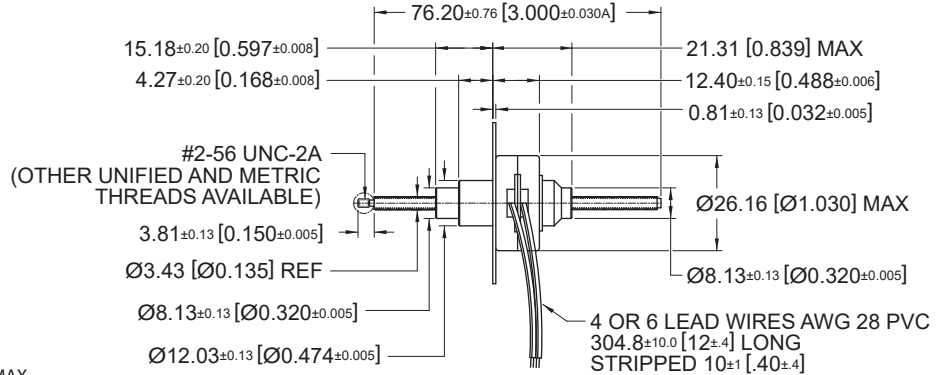
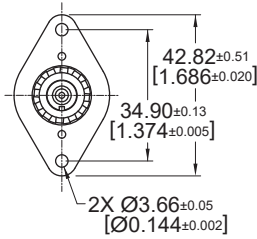

NOTE: SHAFT AXIAL BACKLASH : 0.15 [.006] MAX.

Dimensions in mm. [inches]

Electrical Data	26DAMXX•••-L				Unit
	D1B Bipolar	D2B Bipolar	D1U Unipolar	D2U Unipolar	
1 Operating Voltage #	5	12	5	12	VDC
2 Resistance per Phase, ± 10%	14.6	84.0	14.6	84.0	Ohms
3 Inductance per Phase, typ	6.5	33.6	3.8	20.5	mH
4 Rated Current per Phase, 1 Phase ON	0.48	0.20	0.48	0.20	A
5 Input Power	3.4	3.4	3.4	3.4	W

General Data	XX	Linear travel per step	26DAMXX•••-L				Unit
			D1B Bipolar	D2B Bipolar	D1U Unipolar	D2U Unipolar	
6 Min. Holding Force @ rated current	10	@ .001" (0.0254mm)	33.4 (120)		20 (72)		N (oz)
	20	@ .002" (0.0508mm)	25 (90)		15.3 (55)		N (oz)
	40	@ .004" (0.1016mm)	14.5 (52)		8.9 (32)		N (oz)
7 Min. Holding Force (Unenergized)	10	@ .001" (0.0254mm)			20 (72)		N (oz)
	20	@ .002" (0.0508mm)			13.9 (50)		N (oz)
	40	@ .004" (0.1016mm)			5.56 (20)		N (oz)
8 Stroke Length, Typ					48 (1.89)		mm (in)
9 Linear Travel Accuracy					± 1 Step		
10 Steps per Revolution					24		
11 Ambient Temperature Range (operating)					-20 to +70 (-4 to +158)		°C (°F)
12 Maximum Coil Temperature					130 (266)		°C (°F)
13 Bearing Type					Ball Bearing		
14 Insulation Resistance at 500 VDC					20		Mohms
15 Dielectric Withstanding Voltage					650 for 2 seconds		VAC
16 Weight					34 (1.2)		g (oz)
17 Leadwire					AWG #28, UL1429 (80° C, 150 V)		

Notes: 1. All motor data values at 20° C unless otherwise specified – 2. # Voltage in case of voltage driver (indicator R+I)

