

R16

Ø 16 mm • Planetary Gearbox • 0.3 Nm

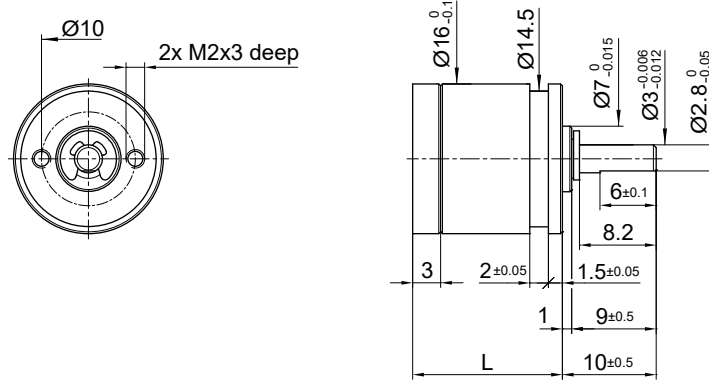

Dimensions in mm.

| Ratio | 5.5 | 22 | 30.2 | 88 | 121 | 166 | 352 | 484 | 665.5 | 915 |
|-------------------------|-----------|---------------|---------------|---------------|---------------|---------------|---------------|---------------|---------------|---------------|
| 1 Number of Gear Stages | 1 | 2 | 2 | 3 | 3 | 3 | 4 | 4 | 4 | 4 |
| 2 Direction of Rotation | = | = | = | = | = | = | = | = | = | = |
| 3 Efficiency | 0.85 | 0.75 | 0.75 | 0.65 | 0.65 | 0.65 | 0.55 | 0.55 | 0.55 | 0.55 |
| 4 L (mm) | 16 | 20.1 | 20.1 | 24.2 | 24.2 | 24.2 | 28.3 | 28.3 | 28.3 | 28.3 |
| 5 Weight | g (oz) | 10 (0.352) | 13 (0.458) | 13 (0.458) | 16 (0.564) | 16 (0.564) | 16 (0.564) | 19 (0.670) | 19 (0.670) | 19 (0.670) |

| 6 Available with Motor – L2 - Length with motor (mm) | 5.5 | 22 | 30.2 | 88 | 121 | 166 | 352 | 484 | 665.5 | 915 |
|--|------|------|------|------|------|------|------|------|-------|------|
| 16C18 | 31.7 | 35.8 | 35.8 | 39.9 | 39.9 | 39.9 | 44 | 44 | 44 | 44 |
| 16N78 | 44 | 48.1 | 48.1 | 52.2 | 52.2 | 52.2 | 56.3 | 56.3 | 56.3 | 56.3 |
| 16G88 | 44 | 48.1 | 48.1 | 52.2 | 52.2 | 52.2 | 56.3 | 56.3 | 56.3 | 56.3 |
| 17S78 | 34.7 | 38.8 | 38.8 | 42.9 | 42.9 | 42.9 | 47 | 47 | 47 | 47 |
| 17N78 | 41.9 | 46 | 46 | 50.1 | 50.1 | 50.1 | 54.2 | 54.2 | 54.2 | 54.2 |
| P110 | 35 | 39.1 | 39.1 | 43.2 | 43.2 | 43.2 | 47.3 | 47.3 | 47.3 | 47.3 |
| 16DCP/16DCT/17DCT CB | 42 | 46.1 | 46.1 | 50.2 | 50.2 | 50.2 | 54.3 | 54.3 | 54.3 | 54.3 |
| 16DCP/16DCT/17DCT PM | 41.5 | 45.6 | 45.6 | 49.7 | 49.7 | 49.7 | 53.8 | 53.8 | 53.8 | 53.8 |
| 16ECP36 | 50.5 | 54.6 | 54.6 | 58.7 | 58.7 | 58.7 | 62.8 | 62.8 | 62.8 | 62.8 |
| 16ECP52 | 66.5 | 70.6 | 70.6 | 74.7 | 74.7 | 74.7 | 78.8 | 78.8 | 78.8 | 78.8 |
| 32BF | 27.2 | 31.3 | 31.3 | 35.4 | 35.4 | 35.4 | 39.5 | 39.5 | 39.5 | 39.5 |

| Characteristics | Unit | R16 • 0 • | R16 2R • 0 • |
|---|------------|--------------------------|-------------------|
| 7 Shaft Bearings | | Sleeve | Ball Bearing |
| 8 Maximum Static Torque | Nm (oz-in) | 1 (141) | 1 (141) |
| 9 Maximum Radial Force @ 8mm from mounting face | N (lb) | 5 (1.12) | 20 (4.5) |
| 10 Maximum Axial Force | N (lb) | 8 (1.8) | 10 (2.2) |
| 11 Maximum Press Fit Force | N (lb) | 100 (23) | 100 (23) |
| 12 Average Backlash @ no-load | | 1.25° | 1.25° |
| 13 Average Backlash @ 0.3 Nm | | 2° | 2° |
| Shaft Play: | | | |
| 14 -radial | µm | ≤ 20 | ≤ 10 |
| 15 -axial | µm | 50-150 | ≤ 50 |
| 16 Maximum Recommended Input Speed | rpm | 7,500 | 7,500 |
| 17 Operating Temperature Range: | °C (°F) | -30 to +65 (-22 to +150) | |

